



ENGINEERING DOBERSEK®

STR System REFERENCE

SORPTION TAILINGS ROASTING PLANT

Services & scope of supply

Turnkey solution contract (technological part): complete process with patented STR System, basic and detail design, supply of equipment, documentation, process control and automation, installation supervision and commissioning, training of personnel

- > Dewatering system
- > Intermediate storage
- > Drying and granulation of filter cake
- > Roasting in the circulating fluidized bed furnace
- > Off-gas dedusting, wet off gas cleaning and desulfurization
- > Cooling and grinding of calcine
- > Cooling system
- > Process and instrument air system
- > Electrical equipment, instrumentation and controls
- > Automated control system
- > Multi-stage off-gas cleaning system including desulfurization plant

BENEFITS:

- > Gold recovery from sorption tailings
- > Considerable increase of total gold recovery
- > Compliance with strict regulations regarding off-gas quality



STR System
SORPTION TAILINGS ROASTING

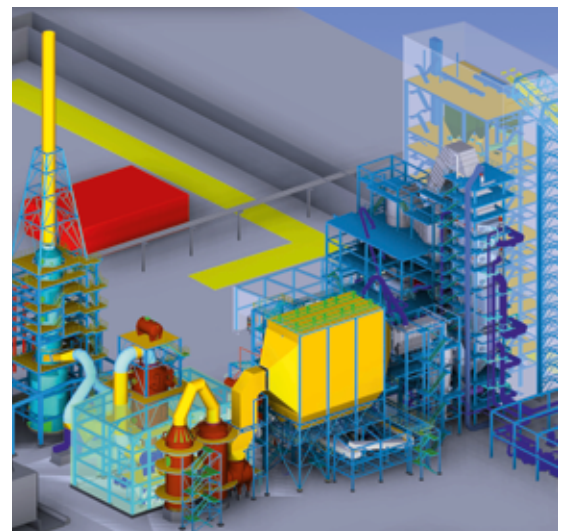

3D-smelting furnace layout

Customer

Navoi Mining & Metallurgical Combinat,
Uchquduq, Republic of Uzbekistan

Commissioning

2019

PROCESSING OF
UP TO

83 t/h

SORPTION TAILINGS



Electrostatic precipitator and wet ball mill



Roasting in the circulating fluidized bed furnace



Drying of filter cake



Material handling



Granulation of filter cake

Engineering Dobersek GmbH
Vorster Straße 493
41169 Mönchengladbach
Germany

t +49 2161 901 08 - 0
f +49 2161 901 08 - 20
e info@ed-mg.de
i www.dobersek.com

Engineering Dobersek GmbH offers the entire spectrum of turnkey plant engineering in the fields of mining, mineral processing, metallurgy, power as well as special plants. Our services range from - depending on individual customer requirements - from research and development, engineering, procurement, construction up to after sales service. Find out more on www.dobersek.com

Engineering Dobersek® is a registered trademark.
STR System is a patented process of Engineering Dobersek GmbH.